

## HP LaserJet 1300 Engine Control PC Board and Related Parts Diagram

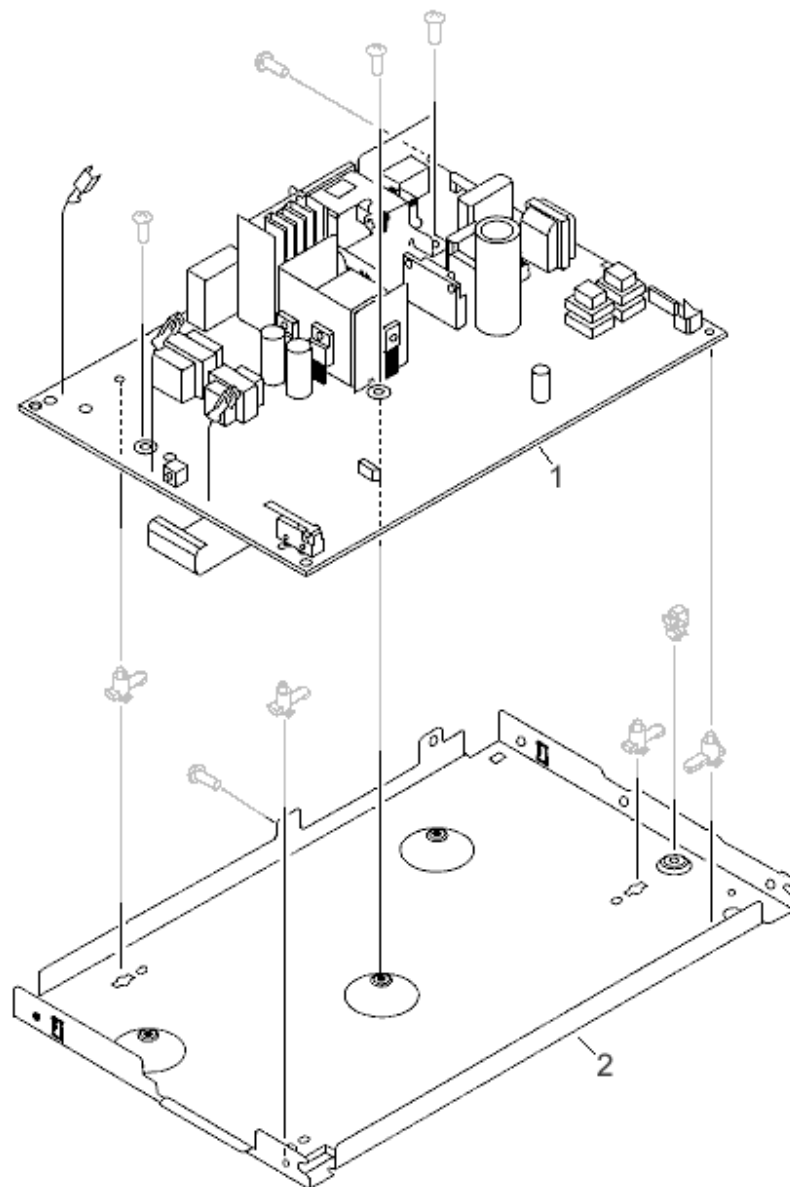

<b>REF</b>	<b>PART #</b>	<b>DESCRIPTION</b>
<b>1</b>	RM1-0564	Engine control PC board - Control and power supply board for the printer (For 110V to 127V operation) - Includes the power cord connector and power switch - Mounts in the bottom of the printer
	RM1-0565	Engine control PC board - Control and power supply board for the printer (For 220V to 240V operation) - Includes the power cord connector and power switch - Mounts in the bottom of the printer
<b>2</b>	RC1-1813	Support pan (case) for the engine controller PC board - Metal pan which also acts as part of the bottom of the printer