

HP LaserJet 3030 All-In-One Printer Internal Components (1 of 3) Diagrams

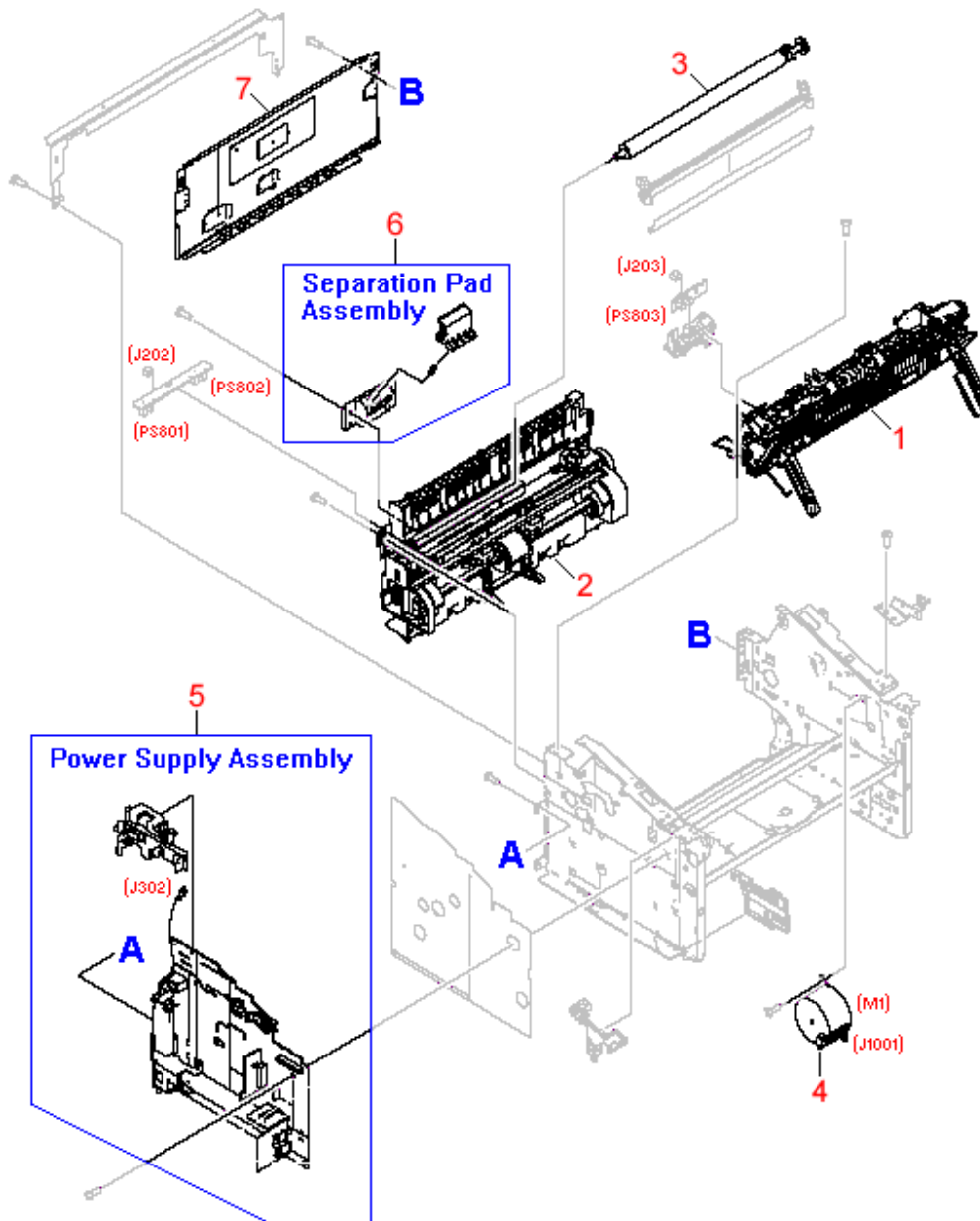

REF	PART #	DESCRIPTION
1	RM1-	Fusing assembly - Bonds the toner to the paper with heat - For 220V to 240VAC

	0863	operation - Mounts to the upper rear of the print engine assembly
	RM1-0865	Fusing assembly - Bonds the toner to the paper with heat - For 110V to 127VAC operation - Mounts to the upper rear of the print engine assembly
2	RM1-0864	Paper pickup assembly - Includes the frame assembly, paper pickup roller assembly, solenoid, feed roller, flags, and other hardware
3	RM1-0658	Transfer roller assembly - Transfers static charge to the media being printed on - Mounts in the top of the paper pickup assembly
4	RK2-0107	Stepping Motor - Main drive motor for the printer - Mounts on the upper front of the internal right frame assembly
5	RM1-0903	Power supply assembly - Includes the power supply board with integrated power switch and power cord receptacle - For 110-127VAC
	RM1-0904	Power supply assembly - Includes the power supply board with integrated power switch and power cord receptacle - For 220-240VAC
6	RM1-0648	SEPARATION PAD ASSEMBLY - BRACKET WITH SPRING LOADED PAD ASSEMBLY - Mounts in the designated slot at the bottom rear of the printer
7	RC1-1985	Lower rear cover assembly - Covers the paper pickup assembly - Larger of the two covers on the rear of the printer