

## HP LaserJet 1320 Internal Components (4 of 4) Diagram

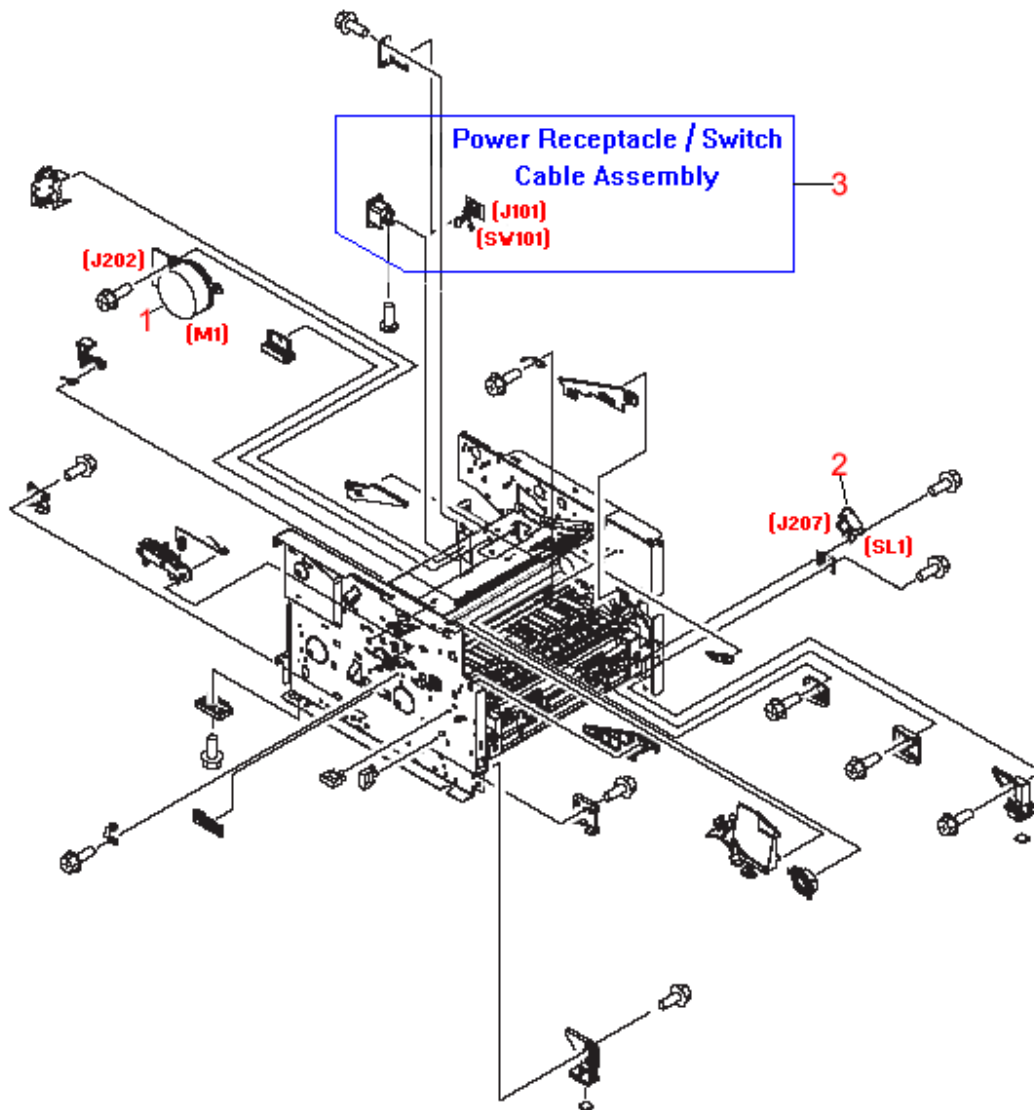

<b>REF</b>	<b>PART #</b>	<b>DESCRIPTION</b>
<b>1</b>	RK2-0418	DC stepper motor assembly - Drives all rollers and fusing assembly via the main drive gear assembly - Mounts on the inside rear of the right side plate assembly
<b>2</b>	RK2-0424	24V DC Solenoid (SL1) - Engages the pickup roller gear/clutch assembly for tray 2 (250-sheet tray) - Mounts on the right side plate assembly
<b>3</b>	RM1-1249	Power receptacle and switch cable assembly - Includes the power cord receptacle, power switch, and cable assembly - Mounts in the lower rear corner of the right side plate assembly